

5/4" CYPRESS
T. & G. LID

2 1/4" FIN. SCREWS
TYP.

PIANO HINGE

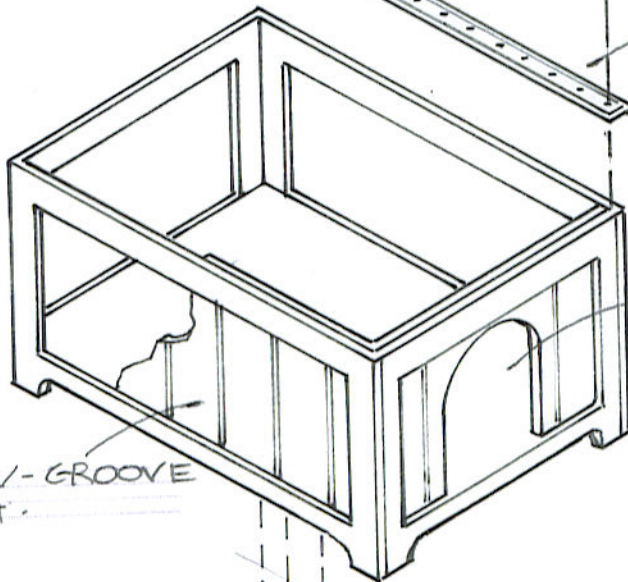

APROX 11" WIDE
ACCESS.

1" X 6" V-GROOVE
T. & G.

1 5/8" FIN. SCREWS.

CAT BOX BENCH

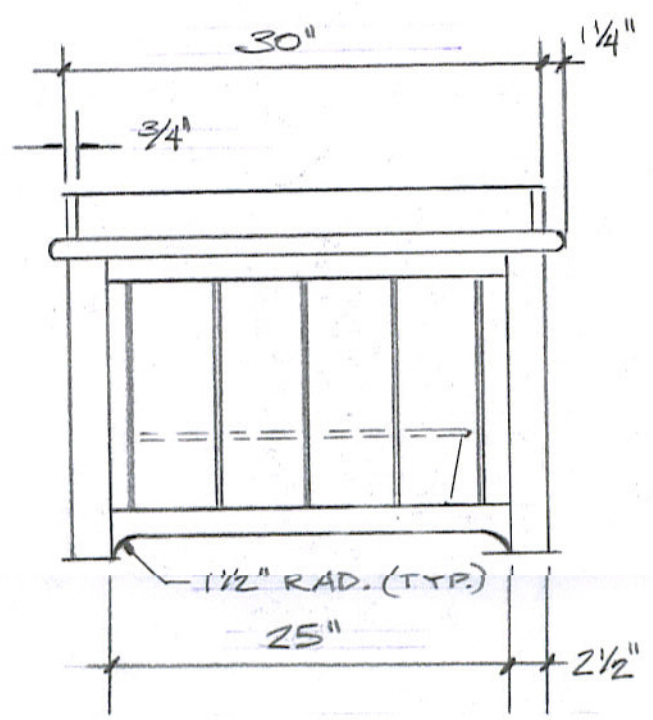

FRONT

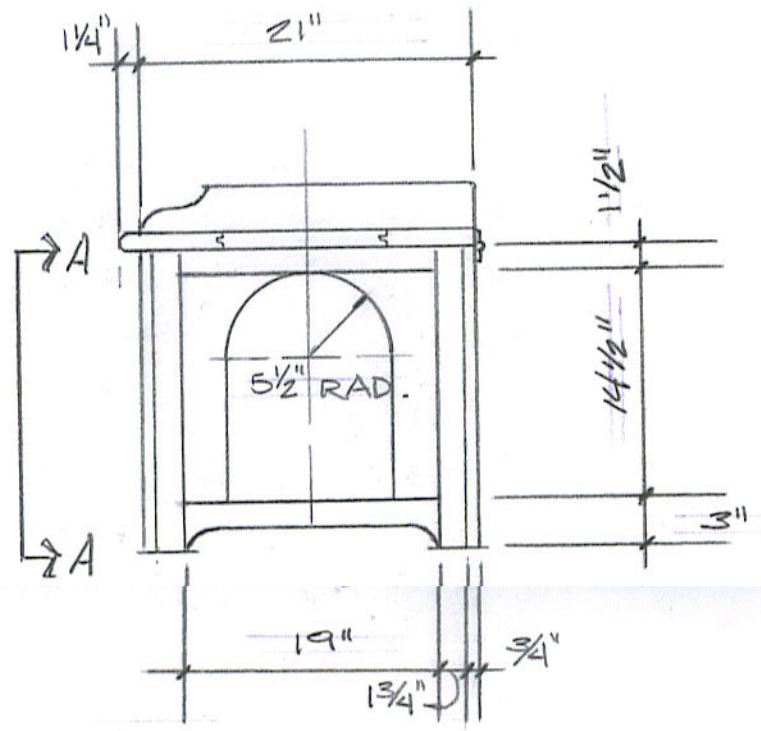

SIDE

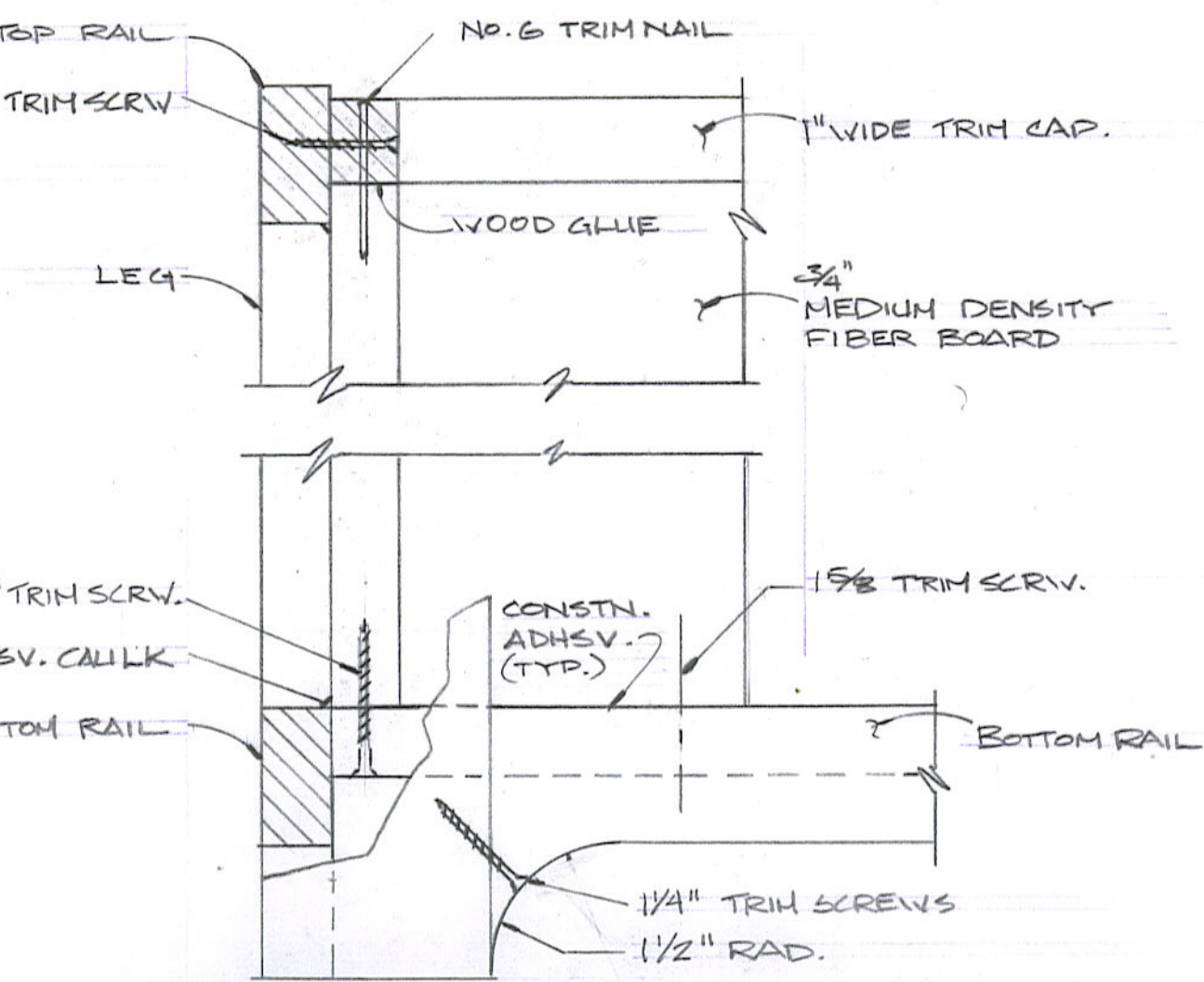

DETAIL A-A

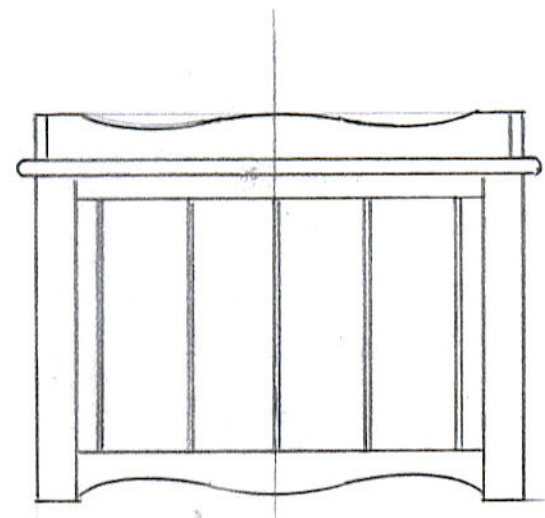

ALT. STYLE
BACK BOARD / BOTTOM RAIL

Cat Box Bench Materials List

- 1 $\frac{3}{4}$ -inch-thick x 19 $\frac{1}{2}$ -inch-wide x 28 $\frac{1}{2}$ -inch-long finished 2-sided birch plywood base
- 1 $\frac{3}{4}$ -inch-thick x 18-inch-wide x 14 $\frac{7}{8}$ -inch-long medium-density fiber board
- 16 1-inch-wide x 6-inch-long pre-primed T&G V-Groves cut to 14 $\frac{7}{8}$ -inches
- 3 $\frac{5}{4}$ -inch-thick x 12-inch-wide x 32 $\frac{1}{2}$ -inch-long T&G cypress tops
- 1 $\frac{3}{4}$ -inch-thick x 2 $\frac{3}{4}$ -inch-wide x 28 $\frac{1}{2}$ -inch-long clear white pine backboard
- 2 $\frac{3}{4}$ -inch-thick x 2 $\frac{3}{4}$ -inch-wide x 21-inch-long clear white pine sideboards
- 10 linear ft. $\frac{3}{4}$ -inch-thick x 1-inch-wide clear white pine cap
- 4 $\frac{3}{4}$ -inch-thick x 2 $\frac{1}{2}$ -inch wide x 19-inch-long pre-primed pine styles/legs
- 4 $\frac{3}{4}$ -inch-thick x 1 $\frac{3}{4}$ -inch-wide x 19-inch-long pre-primed pine styles/legs
- 2 $\frac{3}{4}$ -inch-thick x 1 $\frac{1}{2}$ -inch-wide x 25-inch-long pre-primed pine top rails
- 2 $\frac{3}{4}$ -inch-thick x 1 $\frac{1}{2}$ -inch-wide x 16-inch-long pre-primed pine top rails
- 2 $\frac{3}{4}$ -inch-thick x 3-inch-wide x 25-inch-long pre-primed pine bottom rails
- 2 $\frac{3}{4}$ -inch-thick x 3-inch-wide x 16-inch-long pre-primed pine bottom rails
- 1 1 $\frac{1}{2}$ -inch-wide x 28-inch-long piano hinge
- $\frac{1}{2}$ lb. No. 4d 1 $\frac{1}{2}$ -inch-long bright finish nails
- $\frac{1}{2}$ lb. No. 6d 2-inch-long bright finish nails
- $\frac{1}{2}$ lb. 6 x 1 $\frac{1}{4}$ -inch trim head square drive screws with driver bit
- $\frac{1}{2}$ lb. 6 x 1 $\frac{5}{8}$ -inch trim head square drive screws with driver bit
- 10 fl. oz. construction adhesive
- 8 fl. oz. premium wood glue
- 1 5-pack of 5-inch hook and loop sanding disc (80 grits)
- 1 5-pack of 5-inch hook and loop sanding disc (100 grits)

1 5-pack 5-inch hook and loop sanding disc (120 grits)

2 sheets of 100-grit sandpaper

2 sheets of 120-grit sandpaper

2 sheets of 160-grit sandpaper

10 fl. oz. white adhesive caulk

1 cat litter pan

Primer

Paint

Stain and finish (optional)